

Spare-Parts List and Exploded View

(Ersatzteilliste-Explosionszeichnung)

COOL-LINE-Schnellkühler/Schockfroster **SKF 5 EASY**

[Art. 45110250]



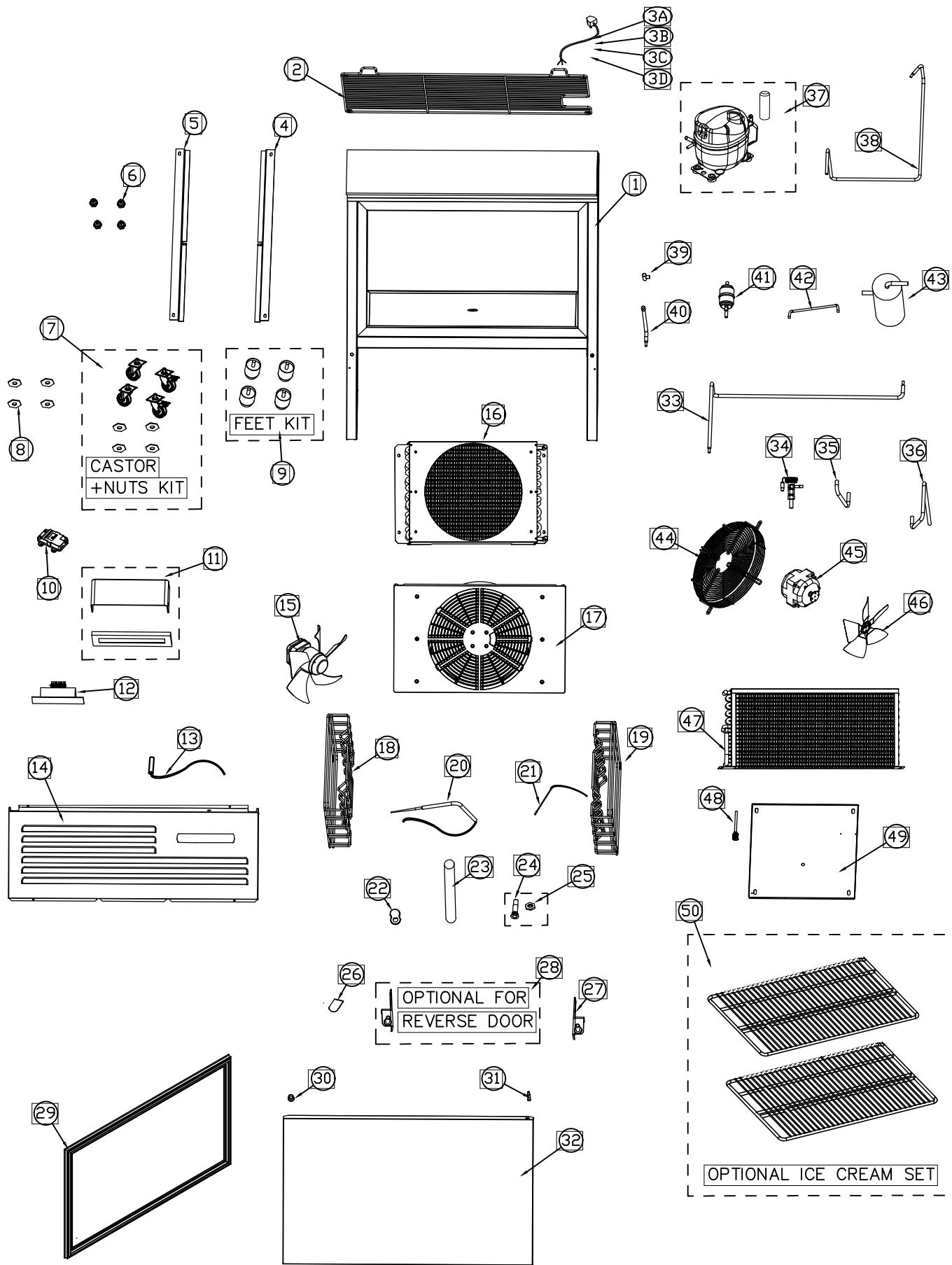

DATE: 2019/12/24	VERSION: A2	NEW COOLING SYSTEM	MODIFIED BY: Alberto
DATE: 2019/2/26	VERSION: A1	NEW FRONT PANEL & DOOR HINGES	MODIFIED BY: Camilla
DATE: 2019/2/25	VERSION: A0	DESCRIPTION	DESIGN BY:
	SCALE	MODEL	Q. TY
	1:1		REMARKS:
MATERIAL: ST1/ST2			
DESIGN BY: Camilla			
APPROVED BY: Alberto			
DATE: 2019/2/25			
CATEGORY		TYPE	GROUP
EV		5AA8	A2
PART N°		1000	

EXPLODED VIEW

Item Description

SKF 5 EASY

BOM Number

1

Build Quantity

1

Fixed Cost

0

Remark

Unit pc

BOM Components

Lev. 0	Item Number	Descr	Quantity	u.m.	Spare Part
	EV5AA8A21000	RF 50A - EXPLODED VIEW DRAWING (Ver.A2 - S10)	1	pc	1
1	S15AA80A2001	RF 50A - ASSEMBLED FOAMED BODY - (From Ver.A2 - S10)	1	pc	1
2	I05AA89A0003	RF 50A - REAR SAFETY ENGINE ROOM GRID - (S10)	1	pc	1
3A	E25EUB315300	POWER CORD 3x1,5 mmq - EU PLUG - BLACK COLOR 3 Mt	1	pc	1
3B	E25UKB315300	POWER CORD 3x1,5 mmq - UK PLUG - BLACK COLOR 3 Mt	1	pc	1
3C	E25AUB315300	POWER CORD 3x1,5 mmq - AUSTRALIAN PLUG - BLACK COLOR 3.0 Mt.	1	pc	1
3D	E25INB315300	POWER CORD 3x1,5 mmq - INDIAN PLUG - BLACK COLOR 3.0 Mt.	1	pc	1
4	S15AA89A0005	RF 50A - BOTTOM/RIGHT GUIDE FOR WATER TRAY - (S10)	1	pc	1
5	S15AA89A0004	RF 50A - BOTTOM/LEFT GUIDE FOR WATER TRAY - (S10)	1	pc	1
6	P05AA89A0006	RF 50A - PLASTIC SCREWS FOR WATER TRAY GUIDES- (S10)	4	pc	1
7	KITCS5AA8A00	RF 50A - BLAST CHILLER CASTOR KIT - (Inc.N.4 Plates-S10)	1	pc	1
8	Z05AA83A0006	RF 50A - CASTOR SPACER PLATE - (S10)	4	pc	1
9	KITFT7AA8B00	QB 200/RF 50A - S/S FEET SET(N.4 FEET BH120- Unit:900mm)-S10	1	pc	1
10	E01A09305427	WIRING BOX (Dim.93mm*54mm*26.5mm)	1	pc	1
11	P05AA81A0005	RF 50A - BOX SET (Dixell WV30H Thermostat-S10)	1	pc	1
12	E20A242B2D00	XW30H DIXELL THERMOSTAT	1	pc	1
13	E305AA800001	RF 50A - DOOR MAGNETIC SENSOR - (S10)	1	pc	1
14	S15AA81A2001	RF 50A - FRONT PANEL - (Item from Ver.A2 Dixell - S10)	1	pc	1
15	E17D1A250000	ECR01B***5 WELLINGTON FAN: 230V; 50/60Hz; CABLE LENGHT 500mm	1	pc	1
16	C05AA87A0003	RF 50A - EVAPORATOR - (From Ver.A2 - S10)	1	pc	1
17	S25AA87A0004	RF 50A - EVAPORATOR FAN INNER COVER- (From Ver.A2 - S10)	1	pc	1
18	S75AA89A0008	RF 50A - SHELF/PANS LEFT CHROME SUPP.- (From Ver.A1 - S10)	1	pc	1
19	S75AA89A0007	RF 50A - SHELF/PANS RIGHT CHROME SUPP.- (From Ver.A1 - S10)	1	pc	1
20	E215AA830003	NEEDLE PROBE - FOR BLAST CHILLER (RF 50A - From Ver.A2 - S10)	1	pc	1
21	E215AA830002	ROOM PROBE - FOR BLAST CHILLER (RF 50A - S10)	1	pc	1
22	R05AA83A0002	RF 50A - INNER CAP FOR DRAIN WATER - (S10)	1	pc	1
23	P05AA83A0003	RF 50A - OUTER BODY DRAIN PIPE - (S10)	1	pc	1
24	P05AA83A0004	RF 50A - BOTTOM JUNCTION FOR DRAIN PIPE and PANS - (S10)	1	pc	1
25	P05AA83A0005	RF 50A - PLASTIC NUTS FOR DRAIN PIPE - (S10)	1	pc	1
26	P05AA82A1006	RF 50A - LEFT/BOTTOM FRONT PANEL SUPPORT (From Ver.A1-S10)	1	pc	1

27	Z05AA82A1003	RF 50A - RIGHT/BOTTOM HINGE - (Items from Ver.A1 - S10)	1	pc	1
28	Z05AA82A1004	RF 50A - LEFT/BOTTOM HINGE (Reverse door from Ver.A1-S10)	1	pc	1
29	R05AA82A0002	RF 50A - DOOR GASKET - (S10)	1	pc	1
30	P05AA82A0007	RF 50A - DOOR BUSHING FOR PIVOT - (S10)	1	pc	1
31	S15AA82A0005	RF 50A - UPPER DOOR SHAFT - (S10)	1	pc	1
32	S15AA82A0001	RF 50A - DOOR SET - (Included GASKET - S10)	1	pc	1
33	C05AA86A0016	RF 50A - CONN.PIPE: EVAP.pipe to TX VALVE (From Ver.A2-S10)	1	pc	1
34	C05AA86A0004	RF 50A - TX VALVE - (DUNAN/ TIES-808-00 - S10)	1	pc	1
35	C05AA86A0017	RF 50A - CONN.PIPE:TX Valve to"T"Junction (From Ver.A2-S10)	1	pc	1
36	C05AA86A0018	RF 50A - CONN.PIPE:"T"Junction to EVAPOR.(From Ver.A2-S10)	1	pc	1
37	E27B2Q3S0000	SC21CNX.2 COMP.SECOP R290-220/240V 50Hz-1.3 HP CSIR:	1	pc	1
38	C05AA86A0019	RF 50A - DISCHARGE PIPE - (From Ver.A2 - S10)	1	pc	1
39	C05AA86A0006	RF 50A - JUNCTION "T" - (S10)	1	pc	1
40	C05AA86A0020	RF 50A - CONN.PIPE:COPPER pipe to SOLID CORE (From A2 -S10)	1	pc	1
41	C05AA86A0003	RF 50A - SOLID CORE DRIER - (DCL-032 - S10)	1	pc	1
42	C05AA86A0021	RF 50A - RETURN PIPE (For ITEMS in R290 -S10)	1	pc	1
43	C05AA86A0022	RF 50A - GAS LIQUID SEPARATOR (From Ver.A2-S10)	1	pc	1
44	E192A2303800	FAN DIAGONAL GUARD GRILLE FOR BLADE D.230mm D.INT=271;W=38mm	2	pc	1
45	E17A6A230700	iQC3612-040111/A02 EBM FAN:2220-240V,50/60Hz	2	pc	1
46	E181A2303401	EBMPAPTS FAN BLADE D.230mm-34*; 820 M3/h	2	pc	1
47	C05AA88A0002	RF 50A - CONDENSER - (From Ver.A2 - S10)	1	pc	1
48	C05AA86A0015	RF 50A - CHARGING VALVE - (S10)	1	pc	1
49	Z05AA83A0007	RF 50A - ENGINE PLATE - (From Ver.A2 - S10)	1	pc	1
50	KITSH5AA8A00	RF 50A – N.2 ICE CREAM CHROME SHELVES SET – (S10)	1	pc	1