

Glastürtiefkühlschrank

MF 180

Ersatzteilliste-Explosionszeichnung

Spare parts list and exploded assembly drawing

Reservedelsliste-Eksploderet

Art. 4778511801

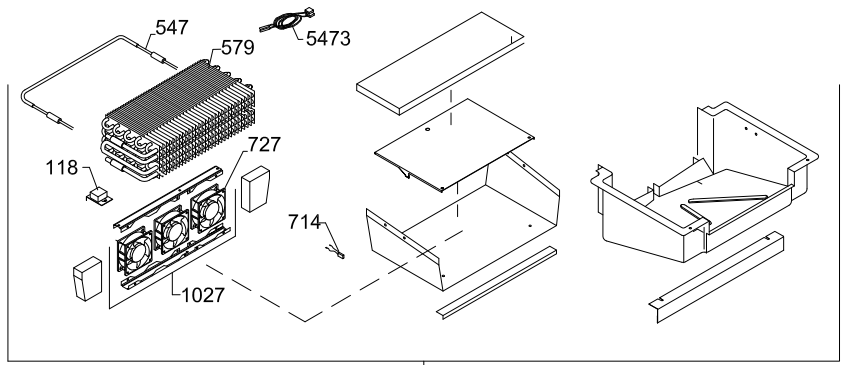
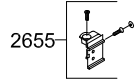
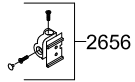
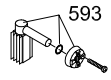

0586 A

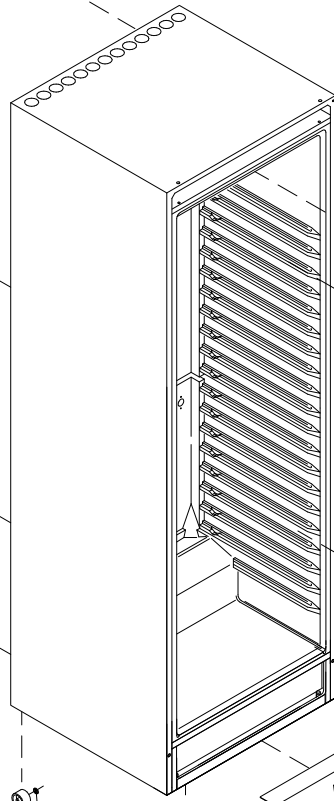
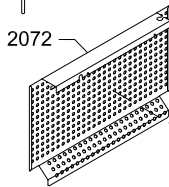
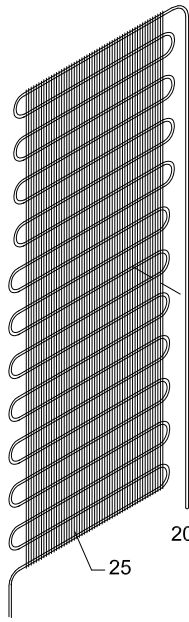

705

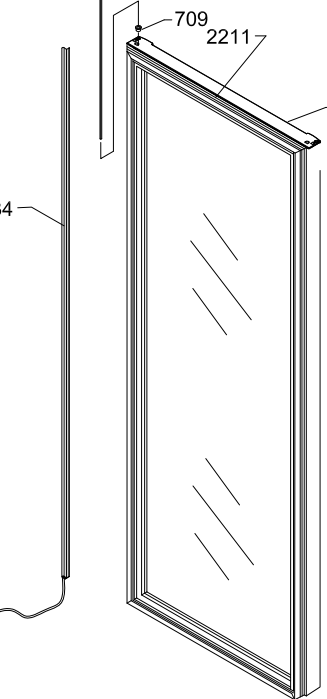

2201

2600

3134

592

67

869

5471

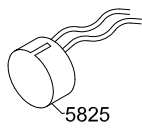
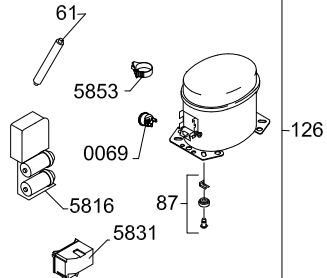

2

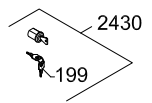
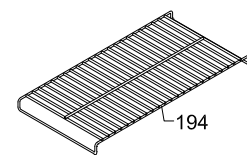
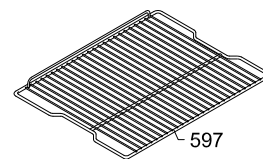
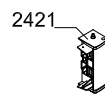
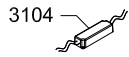
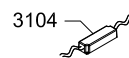

199

Position	Artikelnummer	Artikelname
0025	0-6238149	Kondensator
0061	0-6538001	Trockner,
0067	0-5235002	Rad , komplett
0069	6520415	Überlastschutz
0087	0-6038175	Fussplattenzubehör,, komplett
0117	0-4238008	Zuhalter für Heizkörper
0118	7020227	Bimetallthermostat - Defrost
0126	8-036510287309	Kompressor -NEK2160U Embraco 230V Embraco
0194	0-6938031	Drahtabstellplatte
0199	0-4838236	Schlüssel, Satz - 2 Stück
0547	0-7038140	Heizelement
0579	0-8050204	Verdampfer
0586A	7095174	Verdampferkasten, komplett
0592	0-4238081	Leitkanal
0593	0-4838095	Vakuumventil
0597	0-6938030	Drahtabstellplatte
0702	2042297-03	Scharnier, rechts
0703	2042298-03	Scharnier, links
0705	1510062	Feder
0714	7020992	Thermorelais
0727	7030300	Ventilator
1027	7090166	Ventilator, komplett - 3 im Reihe
2072	2042238-03	Motordeckplatte
2201	0-0280309850	Tür, komplett, glas
2211	3020673-03	Dichtungsleiste
2420	A102530217	"L" Scharnier + Abdeckung
2421	A102530219	"R" Scharnier + Abdeckung + tap
2423	0-20381290103	Fußschraube
2430	0-A9151272	Schloss komplett
2600	0-A90135301	Handgriff
2655	0-A910112	Anschlagflèche für Scharnier, rechts, komplett
2656	0-A910133	Anschlagflèche für Scharnier, links, komplett
3104	7020376	Transformator 12V
3104	7020377	Transformator 24V
3134	7010228	LED light
5471	7095164	Bodenpaneel, Fussleiste - komplett
5473	7020370	NTC-Sensor Kit
5712	7095160	Elektronische Einheit ERC 112D
5816	7095162	CSR elektrische box für NEK2160U
5825	7020375	Transformator
5831	6520416	Deckel
5853	6520409	Halter für Überlastungsschutz
6553	7535377	Netzanschlussleitung
XXXX	1006402	Wire diagram

Änderungen ohne Mitteilung vorbehalten.

Position	Item number	Item name
0025	0-6238149	WOT condenser
0061	0-6538001	Filter drier,
0067	0-5235002	Castor, complete
0069	6520415	Overload Protector
0087	0-6038175	Base plate fittings, complete
0117	0-4238008	Holder strap f. heating element
0118	7020227	Bimetallic Thermostat - Defrost
0126	8-036510287309	Compressor - Complete NEK2160U Embraco 230V
0194	0-6938031	Wire shelf
0199	0-4838236	Key, set - 2
0547	0-7038140	Heating element
0579	0-8050204	Evaporator
0586A	7095174	Evaporator box, complete
0592	0-4238081	Guiding duct
0593	0-4838095	Vacuum valve
0597	0-6938030	Wire shelf
0702	2042297-03	Hinge, right
0703	2042298-03	Hinge, left
0705	1510062	Spring
0714	7020992	Thermal relay
0727	7030300	Fan
1027	7090166	Fan, complete
2072	2042238-03	Engine Cover Plate
2201	0-0280309850	Door, complete, glass
2211	3020673-03	Gasket
2420	A102530217	"L" Hinge + covering
2421	A102530219	"R" Hinge + covering + tap
2423	0-20381290103	Ajustable foot
2430	0-A9151272	Lock complete
2600	0-A90135301	Hand lever
2655	0-A910112	Contact face for hinge, right, complete
2656	0-A910133	Contact face for hinge, left complete
3104	7020376	Transformer - LED 12V
3104	7020377	Transformer, for fans 24V
3134	7010228	LED light
5471	7095164	Bottom panel, complet
5473	7020370	NTC-Sensor Kit
5712	7095160	Electronic controller ERC 112D
5816	7095162	CSR electrical box for NEK2160U
5825	7020375	Transformer - door heating
5831	6520416	Cover
5853	6520409	Bracket for overload protector
6553	7535377	Mains lead
XXXX	1006402	Wire diagram

Subject to changes without prior notice.

Position	Varenummer	Varenavn
0025	0-6238149	WOT condenser for 309, 370, 371, 377, 410, 470, 471 and 581
0061	0-6538001	Tørrefilter,
0067	0-5235002	Hjul - komplet
0069	6520415	Motorbeskytter
0087	0-6038175	Fodpladetailbehør, komplet
0117	0-4238008	Tilhold varmelegeme
0118	7020227	Bimetaltermostat - Defrost
0126	8-036510287309	Kompressor - komplet - NEK2160U Embraco 230V
0194	0-6938031	Trådhylde
0199	0-4838236	Nøgle. sæt - 2 stk.
0547	0-7038140	Varmelegeme
0579	0-8050204	Evaporator
0586A	7095174	Fordamperkasse, komplet
0592	0-4238081	Luftkanal
0593	0-4838095	Vakuumventil
0597	0-6938030	Trådhylde
0702	2042297-03	Tophængsel, højre
0703	2042298-03	Tophængsel - venstre
0705	1510062	Torsionsfjeder
0714	7020992	Termo relæ
0727	7030300	Ventilator
1027	7090166	Ventilator formt. 3 på stribe
2072	2042238-03	Motorrumsafdækning
2201	0-0280309850	Dør, komplet, glas
2211	3020673-03	Gasket
2420	A102530217	"L" Hængsel + Afdækning
2421	A102530219	"R" Hængsel + afdækning + tap
2423	0-20381290103	Stilbare fod
2430	0-A9151272	Lås komplet
2600	0-A90135301	Håndtag
2655	0-A910112	Anlæg for hængsel, højre, samlet
2656	0-A910133	Anlæg for hængsel, venstre, samlet
3104	7020376	Transformator - LED 12V
3104	7020377	Transformator for ventilatorer 24V
3134	7010228	LED lys
5471	7095164	Bundpanel, fodspark - komplet
5473	7020370	NTC-Sensor Kit
5712	7095160	Electronic controller ERC 112D
5816	7095162	CSR elektrisk boks til NEK2160U
5825	7020375	Transformer til dørvarme
5831	6520416	Dæksel
5853	6520409	Beslag til Motorbeskytter
6553	7535377	Netledning
XXXX	1006402	Wire diagram

Ret til ændringer uden varsel forbeholdes.